



MINI-SUMO

CHARACTERISTICS

- ONE OR TWO PUMP MODULES
- MINIMUM LASER LEVEL SWITCH AND VISUAL MAXIMUM LEVEL AS STANDARD
- "QUICK SWAP" PUMP MODULE: EASY OUTPUTS SUBSTITUTION WITHOUT DISRUPTION TO PIPE-WORK DURING PUMP MAINTENANCE
- COMPATIBLE WITH:
 - 02 SYSTEM
 - 26 SYSTEM
- RESERVOIR CAPACITY: 10 KG, 30 KG
- FLOW:
 - 25CM³/MIN (1,52 CU.INCH/MIN) (WITH 1 PUMP MODULE)
 - 50CM³/MIN (3,05 CU.INCH/MIN) (WITH 2 PUMP MODULES)
- WORKING TEMPERATURE: -5°C TO +50 °C
- WITH HEAT MODULE

APPLICATIONS

- HEAVY DUTY APPLICATIONS
- PULP & PAPER
- STEEL INDUSTRY
- LIGHT INDUSTRY
- LARGE MACHINE TOOLS

A COMPACT GREASE PUMP PACKAGE THAT MAINTAINS THE FEATURES, PROVEN RELIABILITY AND ACCESSORY RANGE OF THE SUMO PUMP SERIES

The mini-SUMO Pump is ideal for those applications that use Series 26 - progressive system and 02 Dual Line System. It is designed to feed oil and grease lubrication systems and is compatible with greases up to grade NLGI-2.

Up to each pump modules providing 25cc/min can be installed in tandem configuration with a generous 380bar (5511psi) pressure.

When fitted with two pump modules, the pump continues to deliver grease at maximum pressure even if one pump module becomes ineffective. Pump integrity and function can therefore be maintained until a new pump module can be quickly installed, without the need to disrupt any tubing.

ZERO DOWNTIME DURING PUMP MAINTENANCE

The QUICKSWAP SYSTEM allows to quickly replacement of the PUMP MODULES simply by removing and replacing with new ones. No pipe work needs to be disrupted and this means lower possibility of contamination.

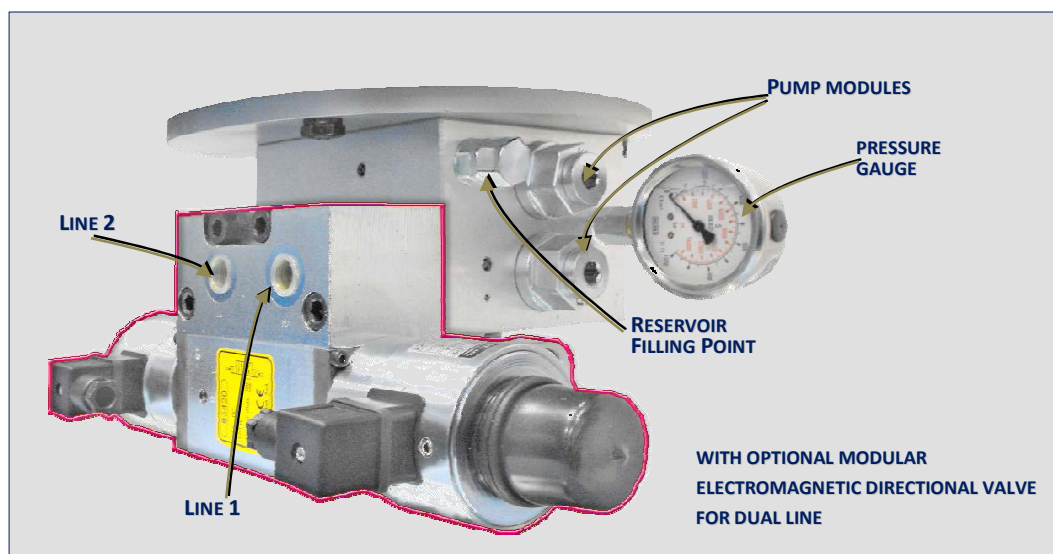
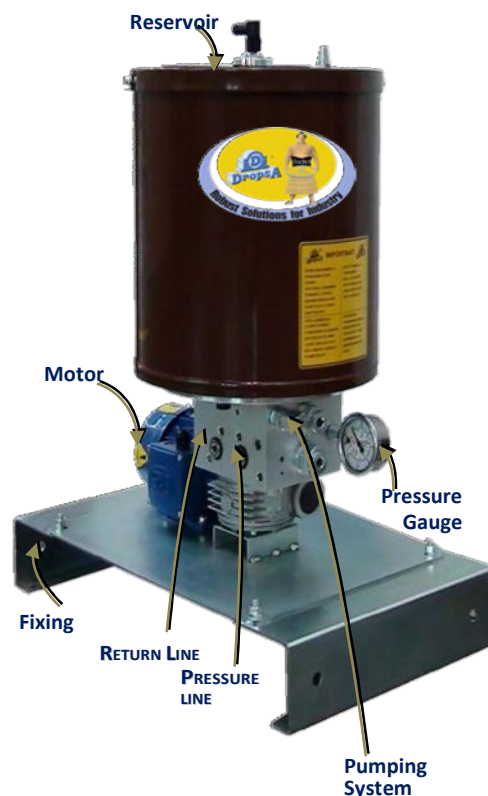



MINI-SUMO

OPERATING PRINCIPLE

THE LUBRICANT IS FED DIRECTLY INTO THE CAM OPERATED PUMP MODULES VIA THE PRESSURE MANIFOLD BLOCK

THE CAMSHAFT ROTATION CREATES AN ALTERNATE PISTON MOTION, ALLOWING GREASE TO BE DRAWN INTO THE PUMP ELEMENT AND PUMPED UNDER PRESSURE TOWARDS THE OUTLET.

THE PUMP ELEMENT HAS A SPRING RETURN THAT ALLOWS THE PUMP MODULE TO RETURN TO ITS STARTING POSITION AND REPEAT THE PUMP CYCLE.

THE GREASE STIRRING PADDLE, LINKED TO THE CAMSHAFT, KEEPS THE GREASE FREE OF AIR POCKETS AND AVOIDS IT CLINGING TO THE SIDE OF THE RESERVOIR. THE RESERVOIR HAS A MAXIMUM VISUAL LEVEL SENSOR LOCATED ON THE TOP PLATE.

THE LUBRICANT - OIL ($32 \div 1000$ CST), OR GREASE ($000 \div 2$ NLGI), IS INTRODUCED INSIDE THE RESERVOIR THROUGH THE REFILL POINT THAT IS EQUIPPED WITH A REFILL FILTER.

DIMENSIONS (NOT TO SCALE)

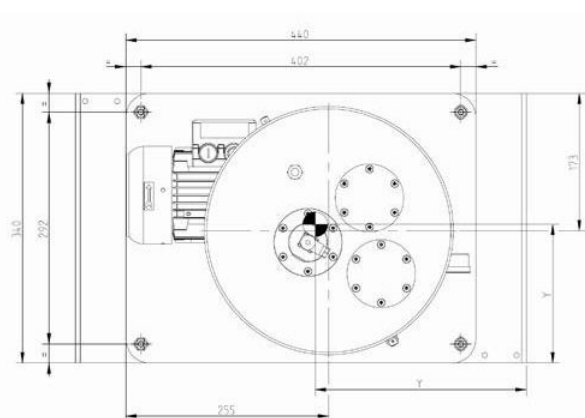
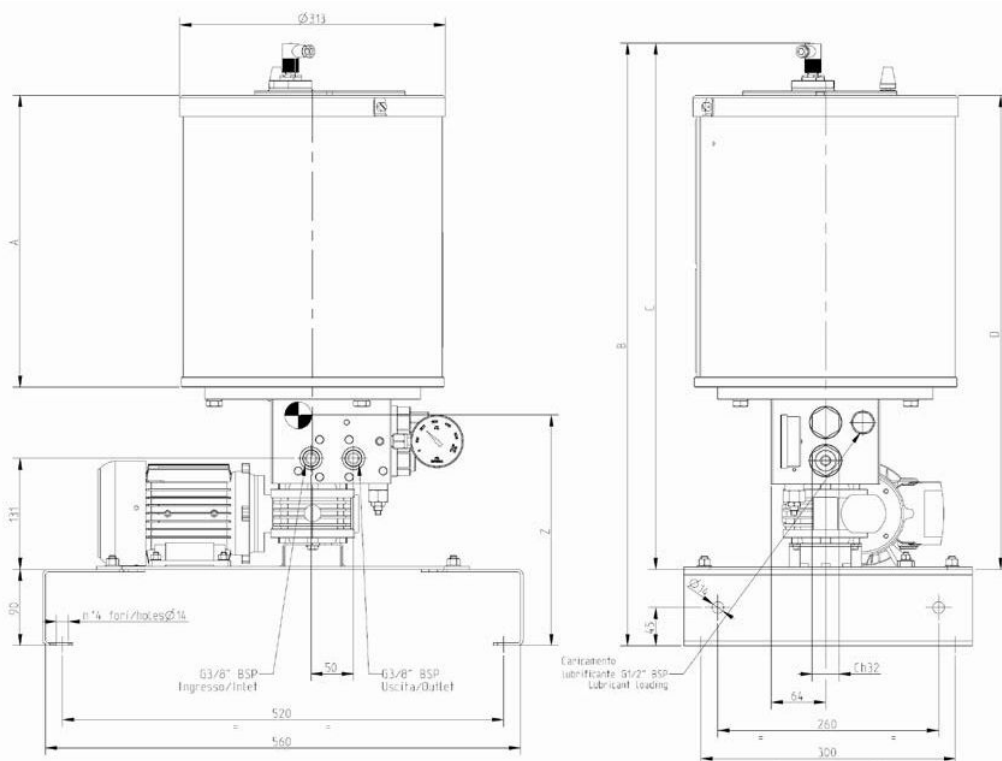

	10 Kg	30 Kg
A	344,5	533,5
B	803	994
C	688	879
D	577	768
Z	275	325
X	265	265
Y	175	175



MINI-SUMO

LUBRICATION SYSTEM EXAMPLES

HYDRAULIC DIAGRAM DUAL LINE SYSTEM

- LUBRICATION SYSTEMS USED ON LARGE SCALE MACHINERY TO LUBRICATE MULTIPLE POINTS ON LARGE MACHINES. THE SYSTEM LENGTH CAN EXCEED 60 METERS AND THE PRESSURE UP TO 400BAR (5511PSI) - DUAL LINE SYSTEM

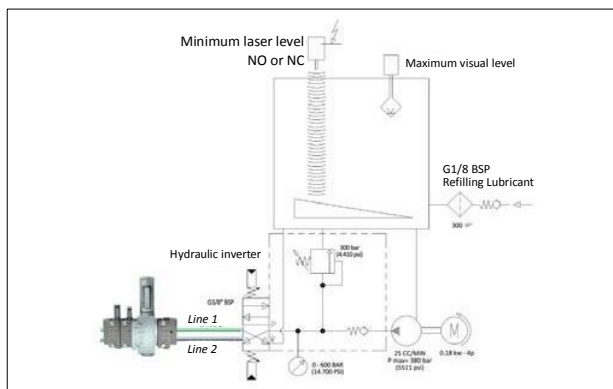
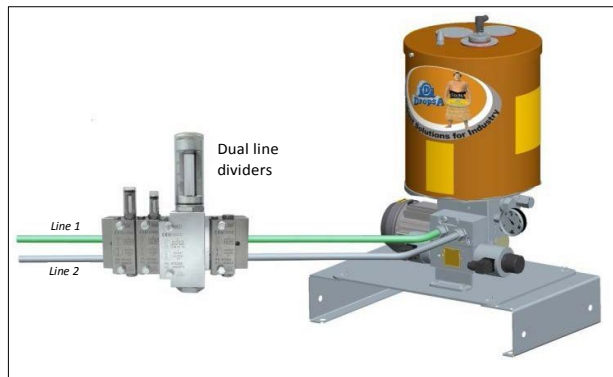

HYDRAULIC DIAGRAM - PROGRESSIVE SYSTEM

- TOTAL LOSS LUBRICATION OIL OR GREASE PROGRESSIVE SYSTEM. - 26 SYSTEM

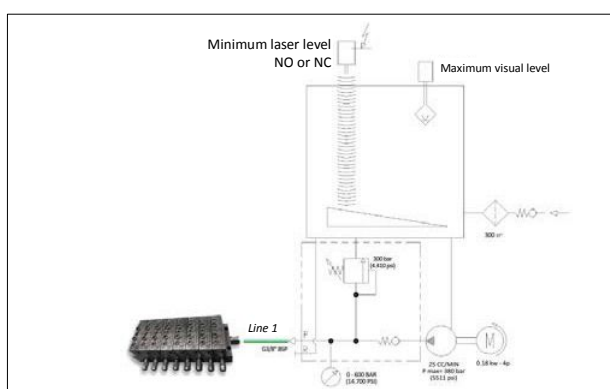
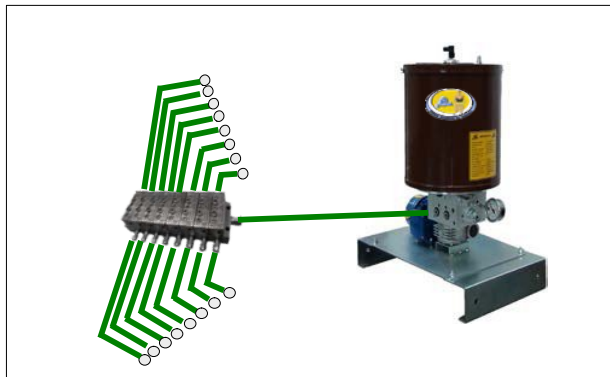

TECHNICAL INFORMATION

TECHNICAL CHARACTERISTICS	
Electric Motor	3PH: 0380÷415Y 220÷240Δ - 50÷60Hz -1340 rpm 440÷480Y 255÷280Δ - 60Hz - 1610 rpm 1PH: 110 V 50 Hz (1370 rpm) 230 V 50 Hz (1370 rpm) 24 V DC 2800 rpm
Pumping system	Piston plunger type
Max working pressure	380 bar
Reservoir capacity	10 L (2,6 USA Gal) or 30 L (7,9 USA Gal)
Flow	25 cm ³ /min (1,52 cu.inch/min) one pump module 50 cm ³ /min (3,05 cu.inch/min) two pump modules
Return Port	G 3/8" BSP
Outlet Port	G 3/8" BSP
Refil Point	G 1/2" BSP
Working temperature	-5 ÷ + 50°C
Lubricants allowed	Mineral oil 32÷1000 cSt/ Grease NLGI2



ORDERING INFORMATION

	SETTING PRESSURE	FLOW	RESERVOIR	MOTOR	PART NUMBER	
Mini-Sumo GREASE	300 Bar	25 cm ³ /min	10 kg	3 Ph - 380÷415Y 220÷240Δ - 50÷60Hz -1340 rpm	<input type="radio"/> 2487000	
				3 Ph - 440÷480Y 255÷280Δ - 60Hz - 1610 rpm	<input type="radio"/>	
				1 Ph - 0,25 Kw - 110 V	<input type="radio"/> 2487010	
				1 Ph - 0,25 Kw - 230 V	<input type="radio"/> 2487011	
			30 Kg	24 V DC	<input type="radio"/> 2487012	
				3 Ph - 380÷415Y 220÷240Δ - 50÷60Hz -1340 rpm	<input type="radio"/> 2487001	
				3 Ph - 440÷480Y 255÷280Δ - 60Hz - 1610 rpm	<input type="radio"/>	
				1 Ph - 0,25 Kw - 110 V	<input type="radio"/> 2487013	
				1 Ph - 0,25 Kw - 230 V	<input type="radio"/> 2487014	
				24 V DC	<input type="radio"/> 2487015	
				10 kg	3 Ph - 380÷415Y 220÷240Δ - 50÷60Hz -1340 rpm	<input type="radio"/> 2487050
					3 Ph - 440÷480Y 255÷280Δ - 60Hz - 1610 rpm	<input type="radio"/>
1 Ph - 0,25 Kw - 110 V	<input type="radio"/> 2487060					
1 Ph - 0,25 Kw - 230 V	<input type="radio"/> 2487061					
Mini-Sumo OIL	300 Bar	25 cm ³ /min.	30 Kg	24 V DC	<input type="radio"/> 2487062	
				3 Ph - 380÷415Y 220÷240Δ - 50÷60Hz -1340 rpm	<input type="radio"/> 2487051	
				3 Ph - 440÷480Y 255÷280Δ - 60Hz - 1610 rpm	<input type="radio"/>	
				1 Ph - 0,25 Kw - 110 V	<input type="radio"/> 2487063	
				1 Ph - 0,25 Kw - 230 V	<input type="radio"/> 2487064	
				24 V DC	<input type="radio"/> 2487065	

OPTIONAL	Oil conversion	Oil float min/max level kit 10 Kg (66lb) + Filling cap with filter	<input type="radio"/> 0295151+ 3130138
		Oil float min/max level kit 30 Kg (66lb) + Filling cap with filter	<input type="radio"/> 0295150+ 3130138
	Terminal board kit	Terminal board support to assemble on board the metal pallet	<input type="radio"/> 3133906

SPARE PARTS	MOTORS	3 Ph - 0,18 Kw - 230Δ/400Y 50Hz - 1350 rpm	<input type="radio"/> 0297002
		277Δ/480Y 60Hz - 1620 rpm	<input type="radio"/>
		UL-CSA - 3 Ph - 0,18 Kw - 330Δ/575Y 60Hz - 1690 rpm	<input type="radio"/> 3301574
		UL-CSA - 3 Ph - 0,18 Kw - 208Δ/360Y 60Hz - 1610 rpm	<input type="radio"/>
		230Δ/400Y 60Hz - 1670 rpm	<input type="radio"/> 3301580
		255Δ/440Y 60Hz - 1710 rpm	<input type="radio"/>
		1Ph - 0,25 Kw - 110V 50Hz	<input type="radio"/> 3301558
		1Ph - 0,25 Kw - 230V 50Hz	<input type="radio"/> 3301559
		24 V – CC	<input type="radio"/> 3301557
		Reducer i=35	<input type="radio"/> 0297001
		Maximum mechanical level kit 10 and 30 Kg (grease)	<input type="radio"/> 0295100
		Laser probe assembly 10÷30 Kg - 24V cc Out NO e NC (1 threshold)	<input type="radio"/> 0295131
		Laser probe assembly 24V cc Out 4÷20mA/2 NO (4 threshold) - 10 kg	<input type="radio"/>
		Laser probe assembly 24V cc Out 4÷20mA/2 NO (4 threshold) - 30 kg	<input type="radio"/> 0295130
		Minimum capacitive level kit (250V AC) 10 Kg (grease)	<input type="radio"/> 0295123
		Minimum capacitive level kit (250V AC) 30 Kg (grease)	<input type="radio"/> 0295121
		Continuous reading ultrasound level 4..20 mA 10 kg	<input type="radio"/>
		Continuous reading ultrasound level 4..20 mA 30 kg	<input type="radio"/> 0295140
		Minimum and maximum level with float 10 Kg (oil)	<input type="radio"/> 0295151
		Minimum and maximum level with float 30 Kg (oil)	<input type="radio"/> 0295150
		Grease loading filter	<input type="radio"/> 0297007
		by-pass	<input type="radio"/> 0234496
		Tank-pump casing gasket	<input type="radio"/> 3190485
		Pressure gauge 0 - 600 Bar	<input type="radio"/> 3292167
		Pumping	<input type="radio"/> 0297010C